

EMERGENCY SW' SMALL CAP

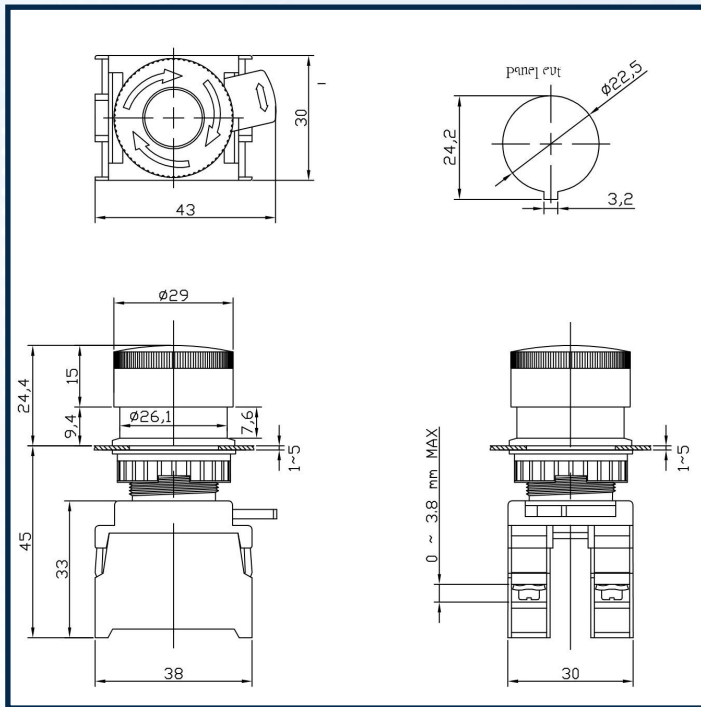

P/N: LM-S22-2NC

MECHANICAL SPECIFICATIONS:

Snap-in contacts.

Twist to release mechanism.

Quick release mechanism to separate the actuator.

Operating cycles: 1,000,000

ELECTRICAL SPECIFICATIONS:

Insulation: 600V.

Contact resistance: 50m Ohm.

Thermal current (Ith) 10A 50/60Hz.

Rating: 3A/240V.

ENVIRONMENTAL SPECIFICATIONS:

Operating temperature range: -20/+60 °C

Water & dust protection: IP65.

Options & information:

Cap size options: 29, 36, 39mm. Colors: Red, Green.

Contacts: NO, NC. Up to 6 contacts in a single switch.

Other options: cap with a key, illuminated cap.

Special marking—Optional.

